

# Building trust

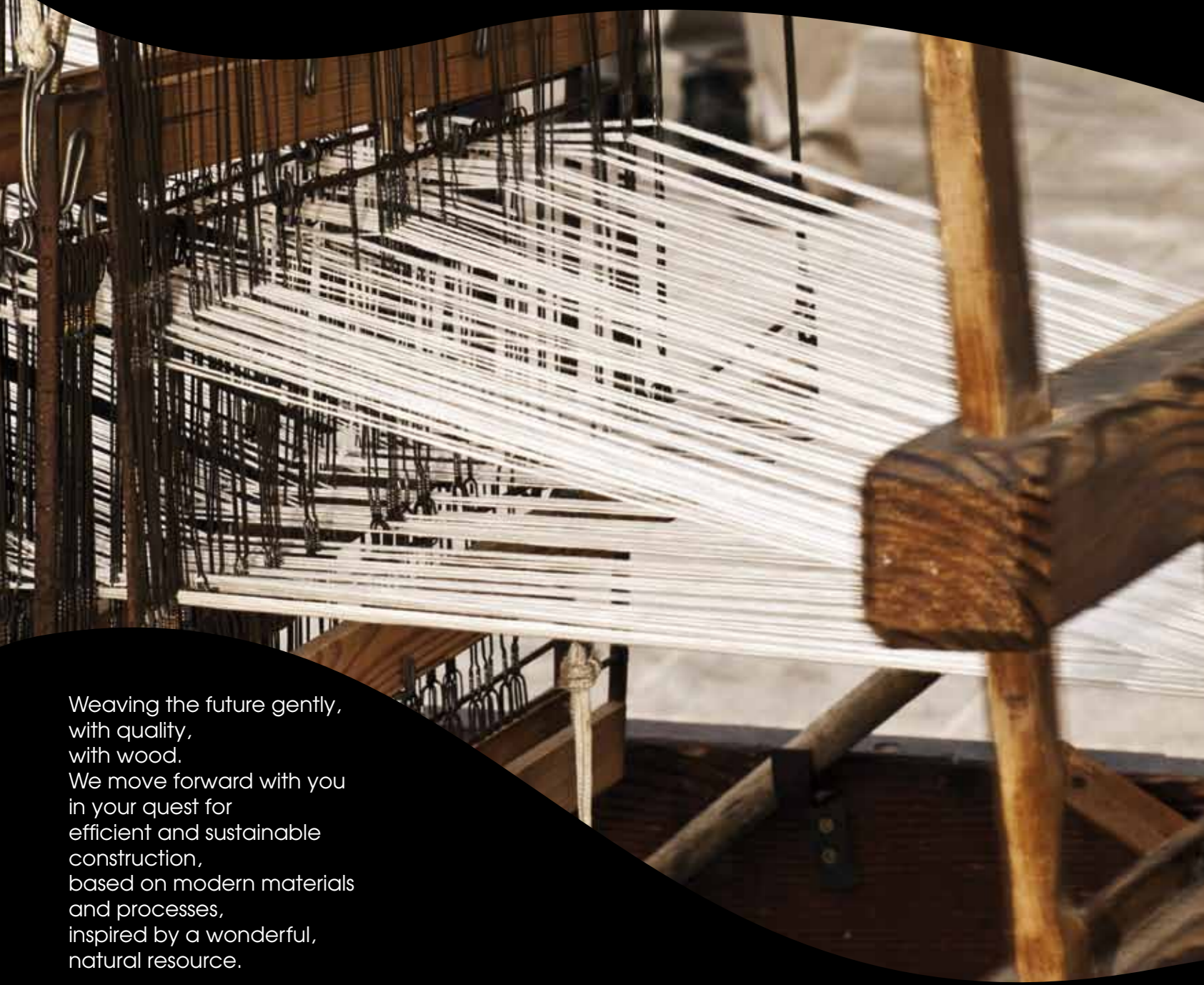

Weaving the future gently, with quality, with wood. We move forward with you in your quest for efficient and sustainable construction, based on modern materials and processes, inspired by a wonderful, natural resource.

[www.egoin.co.uk](http://www.egoin.co.uk)

INTEGRATED CONSTRUCTION · ENGINEERED TIMBER · TECHNOLOGICAL COLLABORATION



EGOIN UK  
44-46 Morningside Road (89) · Edinburgh EH10 4BF · tel. +44 (0) 798 150 9724



**EGOIN BASQUE COUNTRY**  
Astei  
48287 Natxitua-Ea, Bizkaia  
tel. +34 946 276 000  
fax +34 946 276 335

**EGOIN UK**  
44-46 Morningside Road (89)  
Edinburgh EH10 4BF  
tel. +44 (0) 798 150 9724

**EGOIN FRANCE**  
Espace des Templiers RN-10  
64200 Biarritz  
tel. +33 (0) 559 43 69 63



# Building trust

Egoïn retains many of its original values: high work capacity, strong involvement in projects, commitment towards ideas and targets and trust in our partners and clients.

Egoïn is still a family company. Beyond our efforts and our capacity to grow in technology, innovation, product range and services, Egoïn's core principles remain the same: making things right and fulfilling the client's expectations.

Working in proximity with our clients has always been one of our main assets.

We listen, think and suggest. Our capacity to fabricate our own materials, combined with an engineering department which seeks permanent improvement, make us a reliable ally.

Egoïn: building trust.

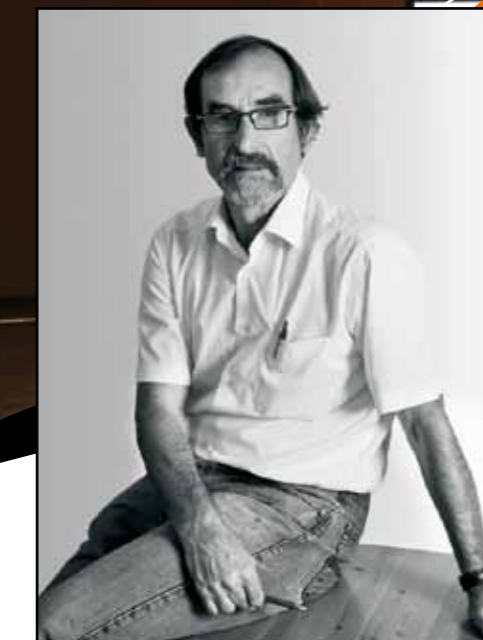

**Peio Gorroño**  
General Manager of Egoïn



# EGO CLT™

EGO\_CLT™ is a solid timber panel made of timber boards glued together in a cross-layered pattern. Panels can reach up to 14000 mm in length and 3800 mm in width. Typical thicknesses range from 60 mm to 225 mm. The weight per panel will depend on size and species.



# EGO CLT MIX™

In the EGO\_CLT MIX™ panels the central layer is replaced by a substructure made of beams, creating a box-shaped cavity within. This cavity is filled with thermo-acoustic insulation: rock wool, sheep wool or wood fibre. These panels have even better mechanical, thermal and acoustic properties and employ less timber than standard CLT panels. They are used mainly for floor/ceiling and roof structures.

We are manufacturers

# TIMBER FRAME

We offer services that optimise the advantages of timber frame construction. We design and calculate the panels that will later be manufactured in our CNC lines, transported on-site and assembled by our team. We possess an extensive knowledge and experience in timber frame construction.



# Services

We have a skilled engineering department for the design, calculation and modelling of new structures. We also provide assessments of existing buildings in need of rehabilitation work and then propose the best solution. We assess, suggest and collaborate.

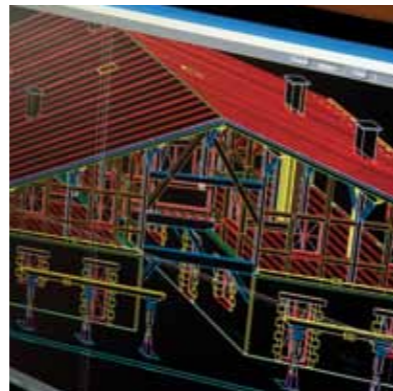

Ego manufactures EGO\_CLT™ and EGO\_CLT MIX™ cross laminated timber panels (CLT), glued laminated beams (glulam), timber frame structures and timber modules.



We also offer transportation and on-site assembly services of our products and structures.

**Ego is the ideal provider of integrated timber construction solutions and a supplier of high quality timber construction products.**



# What we do at egoin

proximity nature technology  
 environmental value unique buildings  
 modular construction involvement  
 commitment harmony energy efficiency  
 service versatility innovation

Wood is an appealing, sustainable and energy efficient material that performs to the highest demands of today's architecture. We make the most of wood's versatility, using it for the manufacture of building components and modules for timber volumetric construction, as well as in the construction of multi-storey buildings. At Ego, sustainability is an essential requirement for the progress of architecture and our communities.

We listen with attention. Our engineering department Analyses and assesses each project. We design and suggest a structural timber solution conforming to the project specifications. We adapt our manufacturing processes to each project. We transport the structure and assemble it on-site. We build all sorts of residential, commercial and educational buildings.

## COMMITMENT TO THE COMMUNITY AND THE ENVIRONMENT

Sustainability, environmental awareness and respect for nature are the core principles of Ego's commitment to the environment. Wood, a renewable and recyclable resource, is the main raw material used in our products. As a natural carbon sink, wood is an excellent sustainable alternative. Furthermore, the energy used in its extraction, processing and manufacturing processes is much less when compared to traditional materials.

Ego works for a better future embracing the community's values and concerns which are, in turn, those of our staff.



## Certificates and approvals

